

100  
0 10  
Millimetres

DO NOT SCALE

KEY:

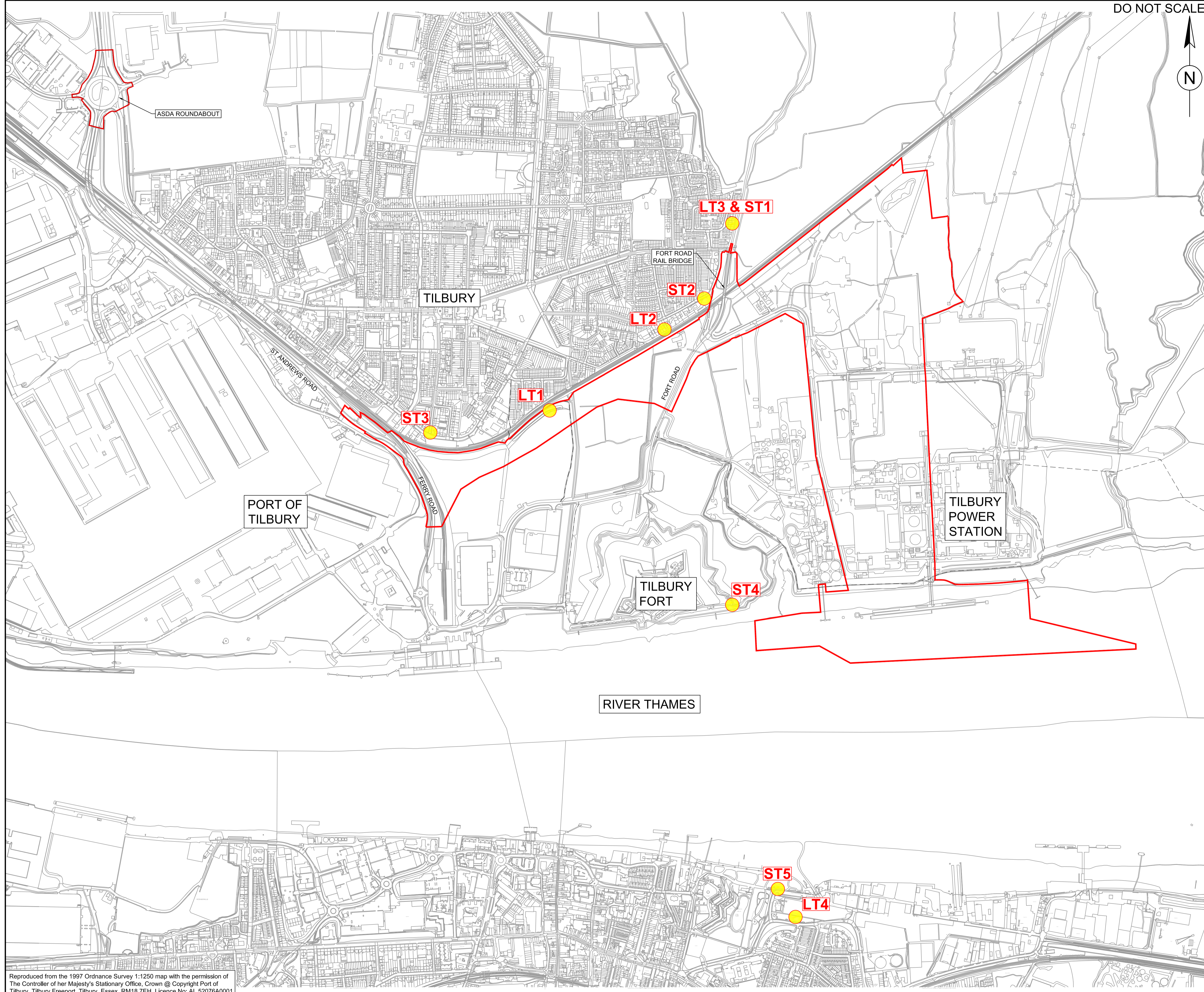
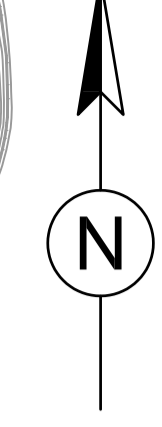

Reproduced from the 1997 Ordnance Survey 1:1250 map with the permission of The Controller of Her Majesty's Stationary Office, Crown © Copyright Port of Tilbury, Tilbury Freeport, Tilbury, Essex, RM18 7EH. Licence No: AL 52076A0001

Rev.	Date	Description	By	Chk'd	App'd
Drawing Status					
<b>PLANNING</b>					Suitability

**ATKINS**

Western House (Block C)  
Peterborough Business Park  
Lynch Wood  
Peterborough  
PE2 6FZ  
Tel: +44 (0)1733 366900  
Fax: +44 (0)1733 366999  
www.atkinsglobal.com

Copyright © Atkins Limited (2017)

Client

PORT OF  
TILBURY  
LONDON

Project Title

TILBURY2

Drawing Title

**NOISE MONITORING LOCATION PLAN**

Scale	Designed	Drawn	Checked	Authorised
N.T.S.		MU	PJ	
Original Size	Date	Date	Date	Date
A3		Aug '17	Aug '17	
Drawing Number	FIGURE 17.1			Revision
				- 0

ES&S: T13/29/19 Date: 19/07/17 10:43:38  
 Filename: P:\ES&S\Projects\Tilbury2\Drawings\FIGURE 17.1\Noise Monitoring Location Plan.dwg